

Maine Power Reliability Project

Team A

WETLAND SUMMARY FORM

Observers: CCP, DWP, KTW Date: 8-22-07
Town: DIXMONT Series: 1-7 B-17
Segment #: 3 CMP Section #: 203 CMP Pole #: 196 Wetland ID #: 1
Stream/Waterbody ID: A3-203-196-1-CH1 Corps plot: Yes No

Dominant NWI Class: PSS1 Other NWI Classes: FEM1

Representative Wetland Vegetation (by Strata):

SHRUBS:

Alnus inc. Cal. can.
Cornus stolon. Eup. macul.
Vib. racem. Gly. grandis
Ilex vert. Onoc. sens.

HERBS:

Representative Wetland Hydrology

Permanently Flooded (approximate depth -) Seasonally Flooded (approximate depth -) Saturated

Hydrologic Indicators: Silt Deposition Water-Stained Leaves
 Water Marks Drift Lines Surface Scouring
 Drainage Patterns Buttressed Trees Elevated Roots

Other Observations: HILLSIDE SEEPS/ERODED PASTURE

Representative Wetland Soils:
 Mineral
 Organic

Depth	Horizon	Color	Redox Features	Texture
0-12"	Ap	10YR 3/2	Φ	L
12-22"	Bg	10YR 4/2	F, E, D	SL, 15% CR
22-				
27" +	C	2.5Y 5/3	C, M, F	↓

Other Observations:
Meets NEIWPCC (2004) Criteria VII Monarda loam

Stream # 1 Data:
Width (Bank-Bank): 4 ft. Depth @ Center: 3 in. Peren. Intermittent
Bank Configuration: Undercut Vertical Gradual
Channel Substrate: Peat-Muck Silt-Mud Sand Gravel/Cobble Boulder
 Bedrock

Stream # 2 Data:
Width (Bank-Bank): _____ Depth @ Center: _____ Peren. _____ Intermittent _____
Bank Configuration: Undercut Vertical Gradual
Channel Substrate: Peat-Muck Silt-Mud Sand Gravel/Cobble Boulder
 Bedrock

Wildlife Observations/Signs (e.g., tracks/trails, droppings, dams/lodges, browse, dens, egg masses, potential VP):

Notes: NRPA STREAM WITH ASSOCIATED WETLAND.

Cedar Swamp

Wetland of Special Significance

Photo # 1

SKETCH ON BACK

WETLAND SKETCH

C.C. Dorion

Line Flagging Series
1-7
8-17
CH1-8

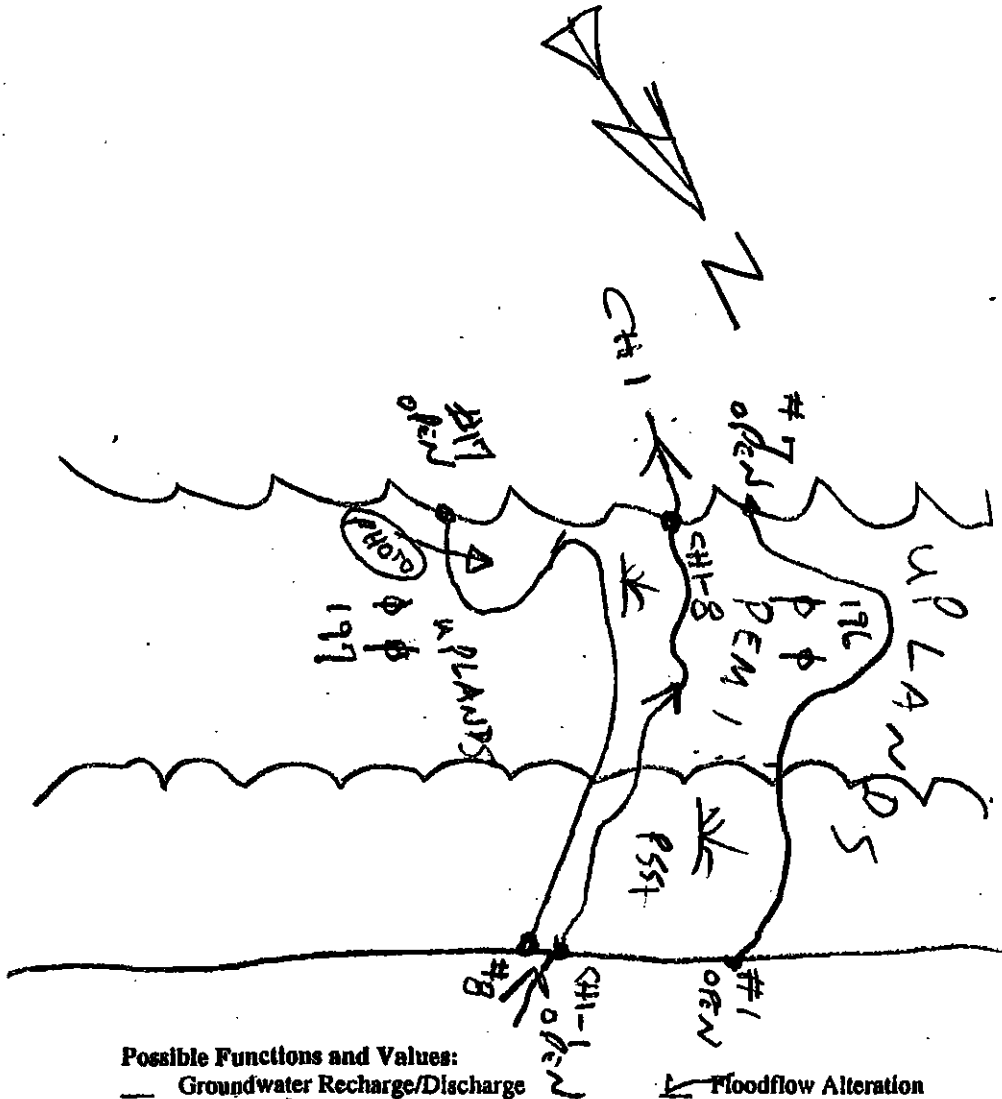

Possible Functions and Values:

- | | |
|---|---|
| <input type="checkbox"/> Groundwater Recharge/Discharge | <input checked="" type="checkbox"/> Floodflow Alteration |
| <input type="checkbox"/> Fish and Shellfish Habitat | <input checked="" type="checkbox"/> Sediment/Toxicant Retention |
| <input checked="" type="checkbox"/> Nutrient Removal | <input type="checkbox"/> Production Export |
| <input type="checkbox"/> Sediment/Shoreline Stabilization | <input checked="" type="checkbox"/> Wildlife Habitat |
| <input type="checkbox"/> Recreation | <input type="checkbox"/> Educational/Scientific Value |
| <input type="checkbox"/> Uniqueness/Heritage | <input type="checkbox"/> Visual Quality/Aesthetics |
| <input type="checkbox"/> Endangered Species Habitat | <input type="checkbox"/> Other |

Checklist:

- Wetland ID# A3-203-196-1
- North arrow.
- Detailed sketch of wetland boundary and flagging sequence.
- Natural and man-made features -- roads, culverts, outcrops, structures, etc.
- Photo locations.
- Location of important wildlife sign.

A3-203-176-1-16

PROJECT TITLE: MRRP		TRANSECT:	PLOT: WETLAND			
DELINEATOR(S): CCD, DPW		DATE: 8-22-07				
VEGETATION	Stratum and Species	Dominance Ratio	Percent Dominance	DOM	NWI Status	
SHRUB:						
	<i>Cornus stolonifera</i>	30%				
	<i>Spiraea latifolia</i>	15				
	<i>Viburnum recognitum</i>	5				
	<i>Ilex verticillata</i>	10				
HERB:						
	<i>Calamagrostis canadensis</i>	80%				
	<i>Onoclea sensibilis</i>	30				
	<i>Eupatorium maculatum</i>	5%				
HYDROPHYTES			NON-HYDROPHYTES			
<u>OBL</u>	<u>FACW</u>	<u>FAC</u>	<u>*OTHER</u>	<u>FAC</u>	<u>FACU</u>	<u>UPL</u>
Hydrophytes Subtotal (A): _____				Non-hydrophytes Subtotal (B): _____		
PERCENT HYDROPHYTES (100A/A+B): _____						
HYDROLOGY						
<input type="checkbox"/> RECORDED DATA						
Stream, lake, or tidal gage Identification: _____						
Aerial photography Identification: _____						
Other Identification: _____						
<input type="checkbox"/> NO RECORDED DATA						
<input checked="" type="checkbox"/> OBSERVATIONS:						
Depth to Free Water: <u>9 inches</u>						
Depth to Saturation (including capillary fringe): <u>AT SURFACE</u>						
Altered Hydrology (explain): <u>FOOTSLAPE OF OLD PASTURE</u>						
<input type="checkbox"/> Inundated	<input type="checkbox"/> Saturated in upper 12"	<input type="checkbox"/> Water Marks	<input type="checkbox"/> Drill Lines	<input type="checkbox"/> Sediment Deposits	<input checked="" type="checkbox"/> Drainage Patterns within Wetland	
<input checked="" type="checkbox"/> OTHER (explain): <u>HILLSIDE SEEPS</u>						

SOIL Sketch landscape position of this plot. Indicate relative position of other plot(s) and the wetland flag if not on plan.

Submission of photo of plot is encouraged.

DEPTH	HORIZON	MATRIX COLOR	REDOXIMORPHIC FEATURES (color, abundance, size, contrast)	COMMENTS (USDA texture, nodules, concretions, masses, pore linings, restrictive layers, root distribution, soil water, etc.)
0-12"	Ap	10YR 3/2	ϕ	L, FR, GR ROOTS: <M - F+M
12-22"	Bg	10YR 4/2	10YR 4/6 F, F, D	SL, FR, SBK ROOTS: F+W - FINE 15% GR
22-29" +	C	2.5Y 5/3	2.5Y 5/2 C, M, F	SL, FR, SBK 15% GR ROOTS: ϕ

HYDRIC SOIL INDICATOR(S): VII REFERENCE(S): Monarda 10am

OPTIONAL SOIL DATA REFERENCE(S):

Taxonomic subgroup:
 Soil drainage class: PD
 Depth to active water table: 9 inches
 NTCHS hydric soil criterion:

CONCLUSIONS

	YES	NO	REMARKS:
Hydrophytic vegetation criterion met?	<input checked="" type="checkbox"/>	<input type="checkbox"/>	
Hydric soils criterion met?	<input checked="" type="checkbox"/>	<input type="checkbox"/>	
Wetland hydrology criterion met?	<input checked="" type="checkbox"/>	<input type="checkbox"/>	
IS THIS DATAPPOINT IN A WETLAND?	<input checked="" type="checkbox"/>	<input type="checkbox"/>	

GENE CORP. PT. Version 7/10/00 Print

PROJECT TITLE: MRRP TRANSECT: PLOT: WETLAND

A3-203-F161-14

PROJECT TITLE: MPRP		TRANSECT: A3-203-176-1-16	PLOT: UPLAND	
DELINEATOR(S):		DATE: 8-22-07		
VEGETATION	Stratum and Species	Dominance Ratio	Percent Dominance	DOM
SHRUBS:				
	<i>Juniperus communis</i>		25%	
	<i>Corylus americana</i>		15%	
	<i>Spiraea latifolia</i>		5%	
HERBS:				
	<i>Poa pratensis</i>		5%	
	<i>Oxalis stricta</i>		5%	
	<i>Oxyclea sensibilis</i>			
	<i>Solidago rugosa</i>		20%	
			10%	
HYDROPHYTES		NON-HYDROPHYTES		
<u>OBL</u>	<u>FACW</u>	<u>FAC</u>	<u>*OTHER</u>	<u>FAC</u>
<u>FACU</u>	<u>UPL</u>	<u>FACU</u>	<u>UPL</u>	<u>UPL</u>
Hydrophytes Subtotal (A): _____		Non-hydrophytes Subtotal (B): _____		
PERCENT HYDROPHYTES (100A/A+B): _____				
HYDROLOGY				
<input type="checkbox"/> RECORDED DATA				
Stream, lake, or tidal gauge Identification: _____				
Aerial photography Identification: _____				
Other Identification: _____				
<input type="checkbox"/> NO RECORDED DATA				
<input checked="" type="checkbox"/> OBSERVATIONS:				
Depth to Free Water: <u>> 24 inches</u>				
Depth to Saturation (including capillary fringe): <u>19 inches</u>				
Altered Hydrology (explain): <u>FOOT SLOPE OF OLD PASTURE</u>				
<input type="checkbox"/> Inundated	<input type="checkbox"/> Saturated in upper 12"	<input type="checkbox"/> Water Marks	<input type="checkbox"/> Drift Lines	<input type="checkbox"/> Sediment Deposits
<input type="checkbox"/> OTHER (explain):		<input type="checkbox"/> Drainage Patterns within Wetland		

SOIL Sketch landscape position of this plot. Indicate relative position of other plot(s) and the wetland flag if not on plan.

Submission of photo of plot is encouraged.

DEPTH	HORIZON	MATRIX COLOR	REDOXIMORPHIC FEATURES (color, abundance, size, contrast)	COMMENTS (USDA texture, nodules, concretions, masses, pore linings, resistive layers, root distribution, soil water, etc.)
0-13"	Ap (FOOTSLIPE ON OLD PASTURE = DEPOSITION)	10YR 3/2	∅	SL, FR, GR, 15% CB
13-19	Bw	10YR 3/4	∅	SL, FR, SBK, 15% CB
19-24 in. +	Bc	10YR 4/3	7.5YR 4/4 F, F, D	SL, FR, SBK, 15% GR

HYDRIC SOIL INDICATOR(S): REFERENCE(S):

OPTIONAL SOIL DATA REFERENCE(S):

Taxonomic subgroup:
 Soil drainage class: **MWD**
 Depth to active water table: **> 24 inches**
 NTCHS hydric soil criterion:

CONCLUSIONS

	YES	NO	REMARKS:
Hydrophytic vegetation criterion met?	<input type="checkbox"/>	<input checked="" type="checkbox"/>	
Hydric soils criterion met?	<input type="checkbox"/>	<input checked="" type="checkbox"/>	
Wetland hydrology criterion met?	<input type="checkbox"/>	<input checked="" type="checkbox"/>	
IS THIS DATAPPOINT IN A WETLAND?	<input type="checkbox"/>	<input checked="" type="checkbox"/>	

FORM-COR-F1 Version 2/10/02 Page 2

PROJECT TITLE: **MRRP** TRANSECT: **A3-203-196-1-** PLOT: **UPLAND**

Maine Power Reliability Project

Team A

WETLAND SUMMARY FORM

Observers: DWP, CCD, KJW Date: 8-21-07
 Town: Dixmont Series: 1
 Segment #: 3 CMP Section #: 203 CMP Pole #: 192 Wetland ID #: 1
 Stream/Waterbody ID: A3-703-1921-CH1 Corps plot: Yes No

Dominant NWI Class: PSS1 Other NWI Classes:

SHRUB: Representative Wetland Vegetation (by Strata): HERB:
Ilex vert.; Myrica Onoc. sens.; Eup. mac.
Vib. cass. gale Carex stricta
Vib. recog. Thalic. pub.
Alnus inc. Sol. gig.
Sparganium

Representative Wetland Hydrology

Permanently Flooded (approximate depth -) Seasonally Flooded (approximate depth - 2") Saturated

Hydrologic Indicators: Silt Deposition. Water-Stained Leaves
 Water Marks Drift Lines Surface Scouring
 Drainage Patterns Buttressed Trees Elevated Roots

Other Observations: STREAM FLOOD PLAIN

Representative Wetland Soils:	Depth	Horizon	Color	Redox Features	Texture
<input checked="" type="checkbox"/> Mineral	0-6"	A1-Mucky	10YR 2/2	Φ	Mucky SILT
<input type="checkbox"/> Organic	6-10	C	10YR 3/2	Φ	SAND
	10-21"	A2-Mucky	2.5Y 3/1	Φ	Mucky SILT
	@ 21"	Boulders	+ LEDGE		

Other Observations: Meets NEIWPCC (2004) Criteria VIII.A. ALLUVIAL SEQUENCE

Stream # 1 Data: 12 ft. NARROWS TO 4 ft.
 Width (Bank-Bank): 12 ft. Depth @ Center: 6 in. Peren. Intermittent
 Bank Configuration: Undercut Vertical Gradual
 Channel Substrate: Peat-Muck Silt-Mud Sand Gravel/Cobble Boulder
 Bedrock

Stream # 2 Data
 Width (Bank-Bank): _____ Depth @ Center: _____ Peren. _____ Intermittent _____
 Bank Configuration: _____ Undercut _____ Vertical _____ Gradual _____
 Channel Substrate: _____ Peat-Muck _____ Silt-Mud _____ Sand _____ Gravel/Cobble _____ Boulder _____
 _____ Bedrock

Wildlife Observations/Sign (e.g., tracks/trails, droppings, dams/lodges, browse, dens, egg masses, potential VP):

Notes: FREE WATER @ 18 in. IN SOIL PFT
NRPA STREAM

Cedar Swamp Wetland of Special Significance

Photo # 4

SKETCH ON BACK

WETLAND SKETCH

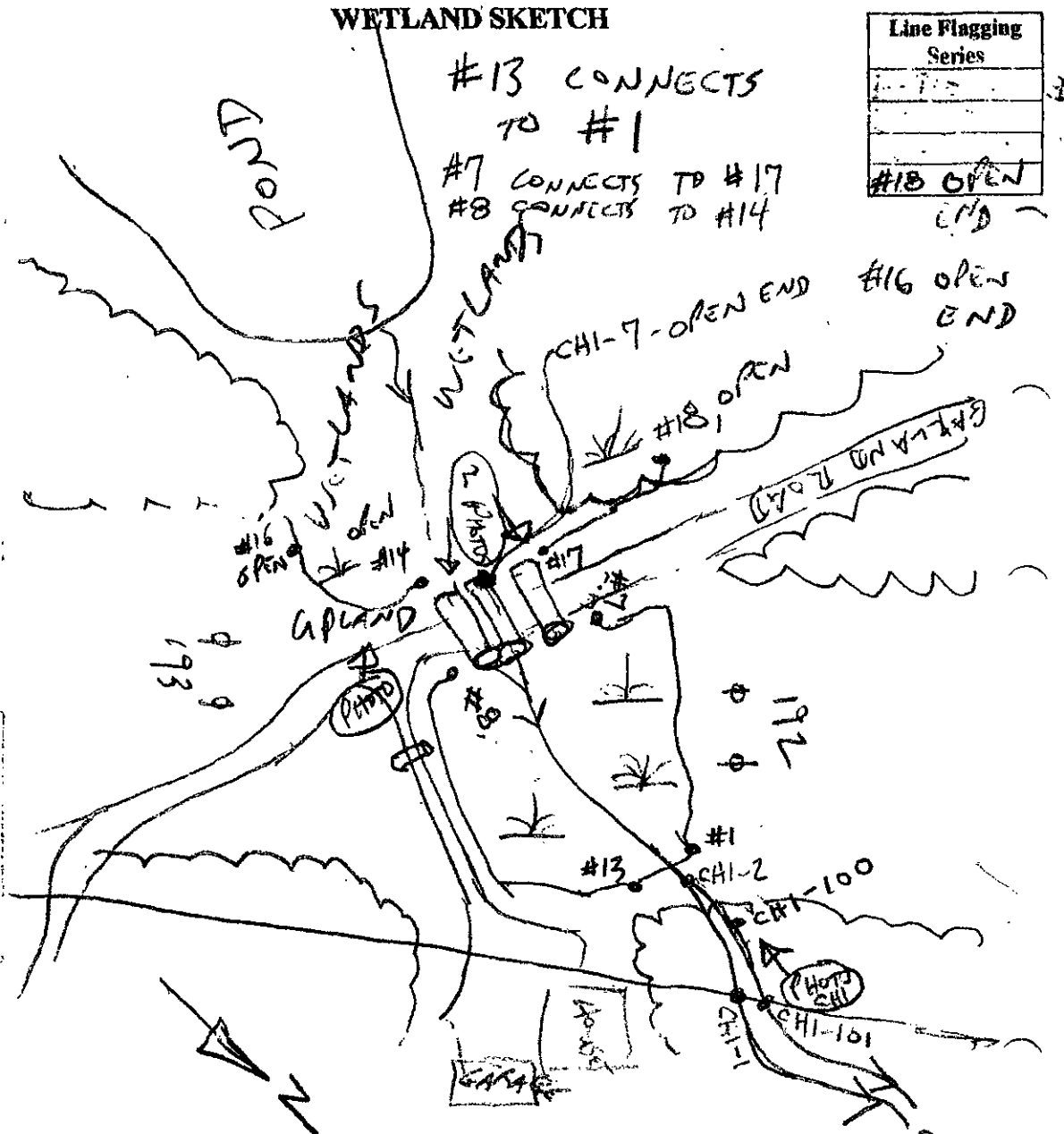

Line Flagging Series
#18 OPEN END

Possible Functions and Values:

- | | |
|--|---|
| <input type="checkbox"/> Groundwater Recharge/Discharge | <input checked="" type="checkbox"/> Floodflow Alteration |
| <input checked="" type="checkbox"/> Fish and Shellfish Habitat | <input checked="" type="checkbox"/> Sediment/Toxicant Retention |
| <input checked="" type="checkbox"/> Nutrient Removal | <input checked="" type="checkbox"/> Production Export |
| <input checked="" type="checkbox"/> Sediment/Shoreline Stabilization | <input checked="" type="checkbox"/> Wildlife Habitat |
| <input type="checkbox"/> Recreation | <input type="checkbox"/> Educational/Scientific Value |
| <input type="checkbox"/> Uniqueness/Heritage | <input checked="" type="checkbox"/> Visual Quality/Aesthetics |
| <input type="checkbox"/> Endangered Species Habitat | <input type="checkbox"/> Other |

- Checklist:**
- Wetland ID# A3-203-192-1
 - North arrow.
 - Detailed sketch of wetland boundary and flagging sequence.
 - Natural and man-made features - roads, culverts, outcrops, structures, etc.
 - Photo locations.
 - Location of important wildlife sign.

Maine Power Reliability Project

Team A

WETLAND SUMMARY FORM

Observers: DWP, GSP, KJW Date: 8-21-07
 Town: DIXMONT Series: 1
 Segment #: 3 CMP Section #: 203 CMP Pole #: 172 Wetland ID #: 2
 Stream/Waterbody ID: NONE Corps plot: Yes No
 Dominant NWI Class: PSS1 Other NWI Classes: POM1

Representative Wetland Vegetation (by Strata):

SHRUB:

Vib. cass.
Vib. racos.
Cornus stolon.

HERB:

Cal. can.
Sol. gig.
Onoc. sens.

Representative Wetland Hydrology

Permanently Flooded (approximate depth -) Seasonally Flooded (approximate depth -) Saturated

Hydrologic Indicators: Silt Deposition Water-Stained Leaves
 Water Marks Drift Lines Surface Scouring
 Drainage Patterns Buttressed Trees Elevated Roots

Other Observations:

Representative Wetland Soils:
 Mineral
 Organic

Depth	Horizon	Color	Redox Features	Texture
0-12"	A1MUCK1	10YR 3/2	G, M, D	MUCK/SL
12-16	A2-MUCK1	10YR 3/1	G, F, P	SL
16-20"+	Gg	2.5Y 4/2	G, C, F	SL

Other Observations:

Meets NEIWPCC (2004) Criteria II RE-GRADED AREA

Stream # 1 Data:

Width (Bank-Bank): _____ Depth @ Center: _____ Peren. _____ Intermittent _____
 Bank Configuration: _____ Undercut _____ Vertical _____ Gradual _____
 Channel Substrate: _____ Peat-Muck _____ Silt-Mud _____ Sand _____ Gravel/Cobble _____ Boulder _____
 _____ Bedrock

Stream # 2 Data

Width (Bank-Bank): _____ Depth @ Center: _____ Peren. _____ Intermittent _____
 Bank Configuration: _____ Undercut _____ Vertical _____ Gradual _____
 Channel Substrate: _____ Peat-Muck _____ Silt-Mud _____ Sand _____ Gravel/Cobble _____ Boulder _____
 _____ Bedrock

Wildlife Observations/Sign (e.g., tracks/trails, droppings, dams/lodges, browse, dens, egg masses, potential VP):

Notes:

Cedar Swamp

Wetland of Special Significance

Photo # _____

SKETCH ON BACK

WETLAND SKETCH

Line Flagging Series
1-5

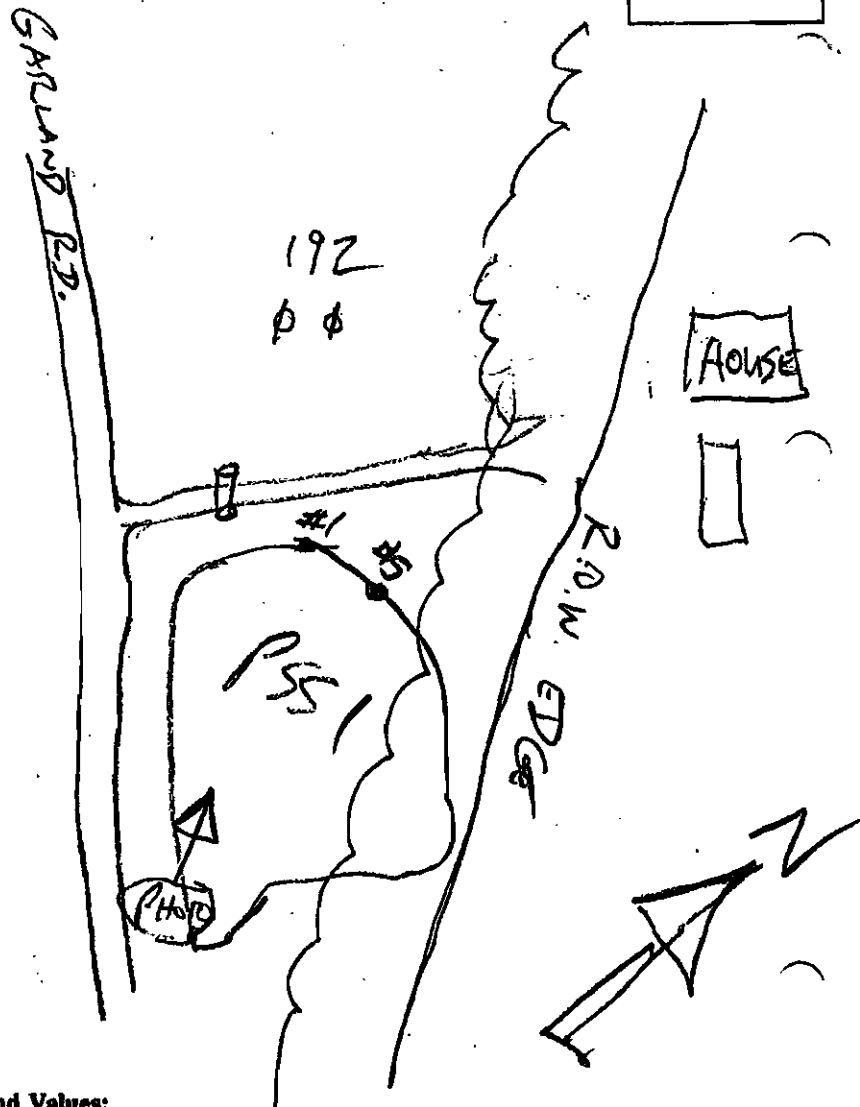

Possible Functions and Values:

- | | |
|---|---|
| <input type="checkbox"/> Groundwater Recharge/Discharge | <input type="checkbox"/> Floodflow Alteration |
| <input type="checkbox"/> Fish and Shellfish Habitat | <input type="checkbox"/> Sediment/Toxicant Retention |
| <input type="checkbox"/> Nutrient Removal | <input type="checkbox"/> Production Export |
| <input type="checkbox"/> Sediment/Shoreline Stabilization | <input type="checkbox"/> Wildlife Habitat |
| <input type="checkbox"/> Recreation | <input type="checkbox"/> Educational/Scientific Value |
| <input type="checkbox"/> Uniqueness/Heritage | <input type="checkbox"/> Visual Quality/Aesthetics |
| <input type="checkbox"/> Endangered Species Habitat | <input type="checkbox"/> Other |

Checklist:

- Wetland ID# A3-203-192-2
- North arrow.
- Detailed sketch of wetland boundary and flagging sequence.
- Natural and man-made features – roads, culverts, outcrops, structures, etc.
- Photo locations.
- Location of important wildlife sign.